

Shaft dia. mm inch	Unit number	Nominal dimensions										Bolt size mm inch	Bearing number	Housing number	Mass of unit Kg
		h	a	e	b	s ₁	s ₂	g	w	Bi	n				
25 13/16 7/8 15/16 1	UCP X05	44.4	159	119	51	17	20	17	85	38.1	15.9	M 14	UC X05	P X05	1.48
	UCP X05-13												UC X05-13		1.53
	UCP X05-14	1-3/4	6-17/64	4-11/16	2-1/64	43/64	25/32	43/64	3-11/32	1.5000	0.6260	1/2	UC X05-14		1.51
	UCP X05-15												UC X05-15		1.49
	UCP X05-16												UC X05-16		1.47
30 1-1/16 1-1/8 1-3/16 1-1/4	UCP X06	47.6	175	127	54	17	20	20	93	42.9	17.5	M 14	UC X06	P X06	1.85
	UCP X06-17												UC X06-17		1.87
	UCP X06-18	1-7/8	6-57/64	5	2-1/8	43/64	25/32	25/32	3-21/32	1.6890	0.6890	1/2	UC X06-18		1.86
	UCP X06-19												UC X06-19		1.83
	UCP X06-20												UC X06-20		1.82
35 1-1/4 1-5/16 1-3/8 1-7/16	UCP X07	54.0	203	144	57	17	20	21	105	49.2	19.0	M 14	UC X07	P X07	2.49
	UCP X07-20												UC X07-20		2.53
	UCP X07-21	2-1/8	7-63/64	5-43/64	2-1/4	43/64	25/32	53/64	4-9/64	1.9370	0.7480	1/2	UC X07-21		2.52
	UCP X07-22												UC X07-22		2.51
	UCP X07-23												UC X07-23		2.47
40 1-1/2	UCP X08	58.7	222	156	65	20	23	23	112	49.2	19.0	M 16	UC X08	P X08	3.13
	UCP X08-24	2-5/16	8-47/64	6-9/64	2-9/16	25/32	29/32	29/32	4-13/32	1.9370	0.7480	5/8	UC X08-24		3.17
45 1-5/8 1-11/16 1-3/4	UCP X09	58.7	222	156	67	20	23	25	116	51.6	19.0	M 16	UC X09	P X09	3.35
	UCP X09-26												UC X09-26		3.50
	UCP X09-27	2-5/16	8-47/64	6-9/64	2-41/64	25/32	29/32	63/64	4-9/16	2.0315	0.7480	5/8	UC X09-27		3.41
	UCP X09-28												UC X09-28		3.37
50 1-7/8 1-15/16 2	UCP X10	63.5	240	171	71	20	23	25	126	55.6	22.2	M 16	UC X10	P X10	4.17
	UCP X10-30												UC X10-30		4.31
	UCP X10-31	2-1/2	9-29/64	6-47/64	2-51/64	25/32	29/32	63/64	4-61/64	2.1890	0.8740	5/8	UC X10-31		4.20
	UCP X10-32												UC X10-32		4.14
55 2 2-1/16 2-1/8 2-3/16	UCP X11	69.8	260	184	79	25	28	29	137	65.1	25.4	M 20	UC X11	P X11	5.65
	UCP X11-32												UC X11-32		5.86
	UCP X11-33	2-3/4	10-15/64	7-1/4	3-7/64	63/64	1-7/64	1-9/64	5-25/64	2.5630	1.0000	3/4	UC X11-33		5.83
	UCP X11-34												UC X11-34		5.80
	UCP X11-35												UC X11-35		5.63

Remark: 1) Regular production in "J" tolerance.
 2) Bearing unit with grease holes and grease groove.
 3) Bearing unit without stop pin.

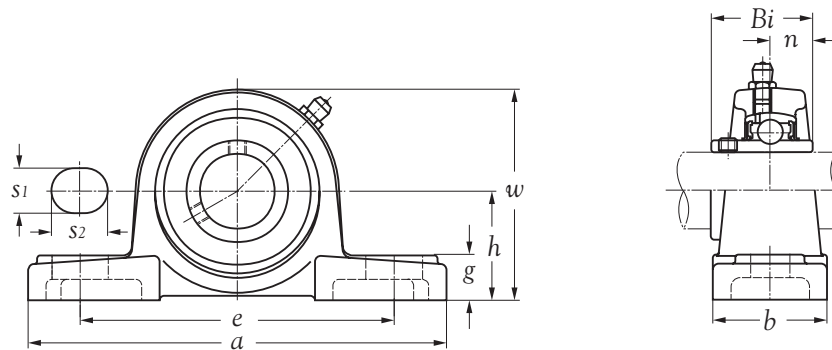

Shaft dia. mm inch	Unit number	Nominal dimensions										Bolt size mm inch	Bearing number	Housing number	Mass of unit Kg
		h	a	e	b	s ₁	s ₂	g	w	Bi	n				
60 2-1/4 2-5/16 2-3/8 2-7/16	UCP X12	76.2	280	203	81	25	28	31	149	65.1	25.4	M 20 3/4	UC X12	P X12	6.80
	UCP X12-36												UC X12-36		6.86
	UCP X12-37	3	11-1/64	7-63/64	3-3/16	63/64	1-7/64	1-7/32	5-55/64	2.5630	1.0000		UC X12-37		6.83
	UCP X12-38												UC X12-38		6.78
	UCP X12-39												UC X12-39		6.70
65 2-1/2 2-9/16	UCP X13	76.2	286	203	83	25	28	33	152	74.6	30.2	M 20 3/4	UC X13	P X13	7.42
	UCP X13-40	3	11-17/64	7-63/64	3-17/64	63/64	1-7/64	1-19/64	5-63/64	2.9370	1.1890		UC X13-40		7.51
	UCP X13-41												UC X13-41		7.37
70 2-5/8 2-11/16 2-3/4	UCP X14	88.9	320	229	85	27	30	34	170	77.8	33.3	M 22 7/8	UC X14	P X14	9.59
	UCP X14-42												UC X14-42		9.63
	UCP X14-43	3-1/2	12-19/32	9-1/64	3-11/32	1-1/16	1-3/16	1-11/32	6-11/16	3.0630	1.3110		UC X14-43		9.61
	UCP X14-44												UC X14-44		9.60
75 2-13/16 2-7/8 2-15/16 3	UCP X15	88.9	330	229	92	27	30	35	175	82.6	33.3	M 22 7/8	UC X15	P X15	10.91
	UCP X15-45												UC X15-45		11.00
	UCP X15-46	3-1/2	12-63/64	9-1/64	3-5/8	1-1/16	1-3/16	1-3/8	6-57/64	3.2520	1.3110		UC X15-46		10.97
	UCP X15-47												UC X15-47		10.94
	UCP X15-48												UC X15-48		10.82
80 3-1/16 3-1/8	UCP X16	101.6	378	283	99	27	30	37	194	85.7	34.1	M 22 7/8	UC X16	P X16	15.09
	UCP X16-49	4	14-7/8	11-9/16	3-57/64	1-1/16	1-3/16	1-29/64	7-41/64	3.3740	1.3425		UC X16-49		15.15
	UCP X16-50												UC X16-50		15.12

- Remark: 1) Regular production in "J" tolerance.
 2) Bearing unit with grease holes and grease groove.
 3) Bearing unit without stop pin.